

LEGAL DESCRIPTIONS:

LOT 1
THAT PORTION OF SECTION 35, TOWNSHIP 20 NORTH, RANGE 15 EAST, W.M., MORE PARTICULARLY DESCRIBED AS FOLLOWS;
LOT 1 OF THAT TAX LOT SEGREGATION SURVEY AS FILED IN BOOK 23 OF SURVEYS ON PAGE 91 AND RECORDED UNDER KITTITAS COUNTY RECORDING NUMBER 199803060020, RECORDS OF KITTITAS COUNTY, SITUATE IN THE COUNTY OF KITTITAS, STATE OF WASHINGTON.

LOT 2
THAT PORTION OF SECTION 35, TOWNSHIP 20 NORTH, RANGE 15 EAST, W.M., MORE PARTICULARLY DESCRIBED AS FOLLOWS;
LOT 2 OF THAT TAX LOT SEGREGATION SURVEY AS FILED IN BOOK 23 OF SURVEYS ON PAGE 91 AND RECORDED UNDER KITTITAS COUNTY RECORDING NUMBER 199803060020, RECORDS OF KITTITAS COUNTY, SITUATE IN THE COUNTY OF KITTITAS, STATE OF WASHINGTON.

LOT 3
THAT PORTION OF SECTION 35, TOWNSHIP 20 NORTH, RANGE 15 EAST, W.M., MORE PARTICULARLY DESCRIBED AS FOLLOWS;
LOT 3 OF THAT TAX LOT SEGREGATION SURVEY AS FILED IN BOOK 23 OF SURVEYS ON PAGE 91 AND RECORDED UNDER KITTITAS COUNTY RECORDING NUMBER 199803060020, RECORDS OF KITTITAS COUNTY, SITUATE IN THE COUNTY OF KITTITAS, STATE OF WASHINGTON.

LOT 4
THAT PORTION OF SECTION 35, TOWNSHIP 20 NORTH, RANGE 15 EAST, W.M., MORE PARTICULARLY DESCRIBED AS FOLLOWS;
LOT 4 OF THAT TAX LOT SEGREGATION SURVEY AS FILED IN BOOK 23 OF SURVEYS ON PAGE 91 AND RECORDED UNDER KITTITAS COUNTY RECORDING NUMBER 199803060020, RECORDS OF KITTITAS COUNTY, SITUATE IN THE COUNTY OF KITTITAS, STATE OF WASHINGTON.

SURVEY NOTES:

- ALL BEARINGS AND DISTANCES ARE WASHINGTON STATE PLANE COORDINATE GRID VALUES (SOUTH ZONE - NAD 83/91) BASED ON THE KITTITAS COUNTY GPS NETWORK, USCGS MONUMENTS AND USFS - WENATCHEE NATIONAL FOREST GPS MONUMENTS. THE COMBINED FACTOR USED FOR THIS PROJECT IS 0.9998681.
- THE CONTROL SURVEY WAS PERFORMED IN OCTOBER 1996 AND MAY THROUGH NOVEMBER, 1997 WITH A THREE SECOND TOTAL STATION, CORNER TIES AND ADDITIONAL CONTROL WAS RUN IN JULY THROUGH NOVEMBER, 1997 USING STATIC & REAL TIME KINEMATIC GPS METHODS BASED ON THE KITTITAS COUNTY CONTROL NETWORK IN CONJUNCTION WITH THE PREVIOUSLY ESTABLISHED NETWORK SET BY EASTSIDE CONSULTANTS. ALL TRAVERSES EXCEED THE MINIMUM ACCURACY STANDARDS AS SET FORTH BY WAC 332-130.
- THE PURPOSE OF THIS SURVEY IS TO IDENTIFY THE EXTERIOR BOUNDARIES OF THE PARCELS AS DESCRIBED AND TO THEN ADJUST THESE BOUNDARIES TO THE CONFIGURATION AS SHOWN HEREON.
- REFERENCE IS MADE TO THE FOLLOWING RECORDS OF SURVEY WHICH WERE USED TO CALCULATE AND/OR ASCERTAIN THE BOUNDARY AS SHOWN HEREON:
BOOK 4, PAGE 9.
BOOK 8, PAGE 30.
BOOK 23, PAGE 91.

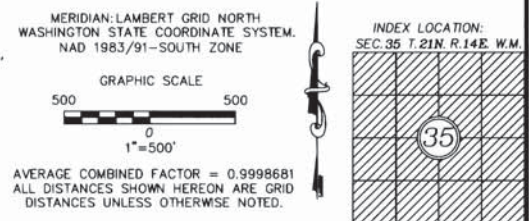

- LEGEND**
- SECTION CORNER
 - QUARTER CORNER
 - FOUND MONUMENT (DESC)
 - SET REBAR WITH L.S. CAP No. 16915.

RECORDER'S CERTIFICATE ...00011020016

Filed for record this 01st day of Nov., 2000, at 1:52 P.M. in book AS.....of Survey page 147 at the request of
ROBERT J. BOGDON
Surveyor's Name

Mgr. _____ Supt. of Records _____

SURVEYOR'S CERTIFICATE

This map correctly represents a survey made by me or under my direction in conformance with the requirements of the Survey Recording Act at the request of PLUM CREEK TIMBER COMPANY..... in...SEP.....2000.

ROBERT J. BOGDON
Certificate No. 33487.....

EASTSIDE CONSULTANTS, INC.
ENGINEERS-SURVEYORS PHONE: (509)674-7433
516 EAST FIRST FAX: (509)674-7419
CLE ELUM, WA 98922

BOUNDARY LINE ADJUSTMENT
PREPARED FOR
PLUM CREEK TIMBER COMPANY

| | | | |
|----------------------|------------------|------------------|--|
| KITTITAS COUNTY | | WASHINGTON | |
| DWN BY G. WEISER | DATE 9/00 | JOB NO. 00590 | |
| CHKD BY R. BOGDON | SCALE 1"=500' | SHEET 1 OF 1 | |